

TABLE OF CONTENTS

PART IV. DROP-IN DEVICES

APPLICATION NOTE FOR THE DROP-IN DEVICES _____	IV-1
DROP-IN ISOLATORS&CIRCULATORS (0.8-12.2 GHz)_____	IV-2



Part IV. Drop-In Devices

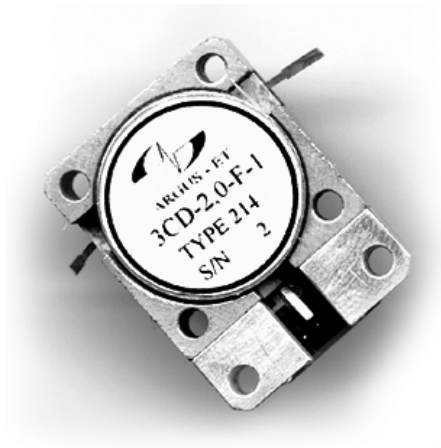

APPLICATION NOTE FOR THE DROP-IN DEVICES

The DROP-IN ferrite isolators and circulators are available in three standard packages and designed for direct integration to stripline or microstrip circuitry. The rugged steel housing provides superior magnetic shielding and through hole mounting. This series is available from 0.800 to 12.2 GHz in various bandwidths.

- **Features**
 - Small size, light weight
 - Low cost.
- **Frequency range**
 - Frequency range of 0.8 to 12.2 GHz.
- **Mechanical mounting**
 - Compatible with 50-ohm adjacent devices.
- **Temperature range**
 - Standard temperature range –30 to 65°C, do not heat above 205°C
 - Electrical parameters perform at standard operating temperature range
 - Other temperature ranges are available.
- **Environmental**
 - Operated in waterproof equipment only
 - Humidity up to 80% none condensing.



DROP-IN ISOLATORS & CIRCULATORS

(0.8 – 12.2 GHz)

MODEL P/N	FREQUENCY (GHz)	BAND WIDTH	INSERTION LOSS (dB)	ISOLATION (dB)	VSWR	LOAD CW. (Watts)	OUTLINE #
3ID-XX-1	0.8 – 1.6	4%	0.3	22	1.20	1 – 75	1, 3
3CD-XX-1	0.8 – 1.6	4%	0.3	22	1.20		2, 4
3ID-XX-1	0.8 – 1.6	8%	0.5	20	1.25	1 – 75	1, 3
3CD-XX-1	0.8 – 1.6	8%	0.5	20	1.25		2, 4
3ID-XX-1	1.8 – 2.2	5%	0.3	22	1.20	1 – 75	5
3CD-XX-1	1.8 – 2.2	5%	0.3	22	1.20		6
3ID-XX-1	1.8 – 2.2	10%	0.5	20	1.25	1 – 75	5
3CD-XX-1	1.8 – 2.2	10%	0.5	20	1.25		6
3ID-2.0-F-1	1.8 – 2.2	Full	0.7	18	1.30	1 – 75	5
3CD-2.0-F-1	1.8 – 2.2	Full	0.7	18	1.30		6
2ID-7.8-2	7.1 – 8.5	Full	0.4	20	1.25	10	8
2ID-8.9-2	8.2 – 9.6	Full	0.4	20	1.25	10	8
2ID-12-1	11.6 – 12.2	Full	0.5	19	1.25	1	7

(xx) Identifies the center frequency of the device in GHz.

OUTLINE #	DIMENSIONS, mm										Fig
	W	L	A	B	C	D	E	F	h	H (max)	
1	25.40	31.75	20.80	20.80	3.5	2.4	7.75	2.30	3.70	8.10	1
2	25.40	25.40	20.80	20.80	3.5	2.4	7.75	2.30	3.70	8.10	2
3	25.40	25.40	20.80	20.80	3.8	2.95	7.62	2.30	3.80	6.35	3
4	25.40	25.40	20.80	20.80	3.8	2.95	7.62	2.30	3.80	6.35	2
5	19.05	25.40	14.50	14.50	2.0	2.4	6.22	2.28	3.00	8.10	1
6	19.05	19.05	14.50	14.50	2.0	2.4	6.22	2.28	3.00	8.10	2
7	12.7	15.30	9.65	11.33	2.3	1.9	4.32	1.50	2.50	9.50	1
8	12.7	15.30	9.65	11.33	1.27	1.9	5.20	1.50	1.78	6.30	1

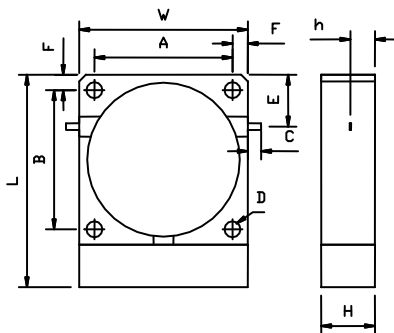

Fig.1

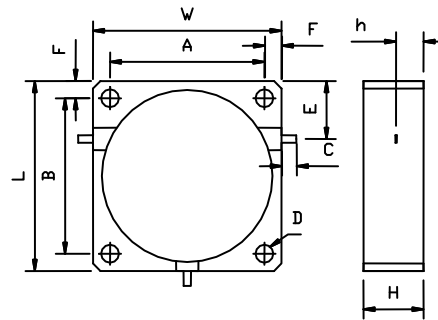

Fig.2

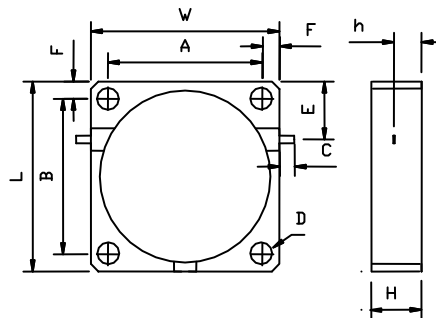

Fig.3